

KEYGRIP

video head

[pro]master[®]
PROFESSIONAL



Congratulations on your purchase of the ProMaster Key Grip Video Head!

Please read these instructions thoroughly to ensure proper operation of your new video head, even if you have used other heads before. With proper use and care, the Key Grip will provide many years of service.

Be sure to refer to the main parts diagram as well as each of the figures throughout the pages as you read. When a specific part of the Key Grip is referred to in **red**, you will find it shown on the main parts diagram and/or in the referenced figure.

Parts Diagram:



ATTACHING YOUR CAMERA (USING THE QUICK RELEASE PLATE)

Unscrew the **handle end cap** from the head's **control handle**, and you will find a set of hex keys stored within the handle. The hex keys can be used for a variety of purposes listed later in this manual. One of the **4mm hex keys** will be used to tighten the **QR plate** to your camera or lens.

Loosen the **QR knob** on the **video head** and remove the **QR plate**. In most cases you will be using the **1/4"-20 mounting bolt**; however, the larger **3/8"-16 mounting bolt** may be necessary with some gear. Professional lenses and cameras often have two mounting holes, for which you can use both the **1/4"-20 bolt** and **3/8"-16 bolts** simultaneously. If you prefer to remove one of the mounting bolts, remove the **soft cover** from the bottom of the **QR plate**, slide the bolt out, and replace the **soft cover**. When mounting any camera or lens, slide the bolt(s) within the slot in the **QR plate** to achieve the best positioning. The plate should be mounted parallel to the direction of your lens. Use one of the **4mm hex keys** stored in the control handle to tighten the mounting bolts. These bolts can also be tightened with a flathead screwdriver. Now place the **QR plate** (with your camera attached) into the top of the **video head** and tighten the **QR knob** to hold it in place. When mounting your camera to the head, slide the **QR plate** back and forth within the **QR platform** to find the best balance point before fully tightening the **QR knob**. Note the location of the plate using the numbered scale on the **QR platform** for future, repeatable mounting in the same place. Notice that the **QR knob** is repositionable—you can pull outward on it, rotate it to a new position, and let go of it. This will change the phase position of the knob without loosening or tightening it. This repositionable feature allows you to set the **QR knob** to the most convenient resting place.

The **QR plate's anti-twist pin** is designed for an anti-twist hole found in the bottom of some cameras and lens mounting rings. If your camera or lens does not have this hole, the spring-loaded pin will retract on its own as the **QR plate** is installed. If preferred, you can remove the pin by unscrewing it from the bottom of the **QR plate** with a flathead screwdriver.

On the bottom side of the **QR plate** you will notice two protruding **safety bolts**. These prevent the **QR plate** and your camera from sliding off the top of the **video head** if the **QR knob** is loosened accidentally. The safety bolts can be removed if you choose using the **2.5mm hex key** stored in the **control handle**. Removing the bolts will allow the **QR plate** to slide into the top of the **video head** more easily, but will eliminate the safety feature. We do not recommend removing the **safety bolts** from the **QR plate**.

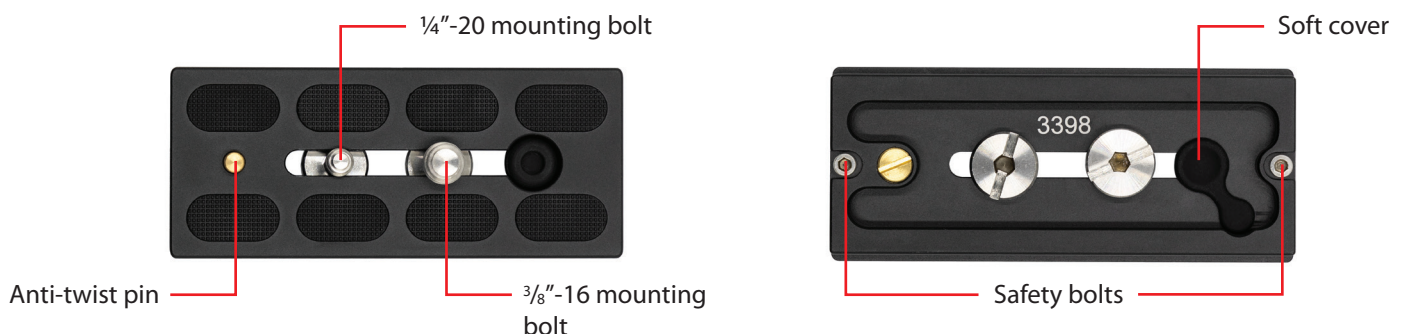

USING THE VIDEO HEAD

The Key Grip is a precision machined aluminum **video head**. It is a 2-way head, meaning there is control for the tilt adjustment and separate control for the panning motion. An extendable **control handle** with a soft, comfortable grip helps achieve smooth panning and tilting motions. The **QR platform** can also be set up in various orientations for front-to-back **QR plate** mounting or side-to-side. Each of these are explained below.

Using the Control Handle

The Key Grip **control handle** is extendable. To unlock the handle in order to extend it, hold the grip and twist to the left. Then, pull back to bring the handle to its full extension, and twist to the right to lock it in place. Reverse this procedure to return the handle to its standard length.

To adjust the handle's angle, loosen the **handle release knob** approximately 1 full turn. Reposition the **control handle** to a comfortable angle, hold it in place and tighten the **handle release knob** to secure its position. Two facing stainless steel rosettes prevent the handle from slipping out of position during use.



Pan and Tilt Adjustments

The Key Grip **video head** has an independent base panning control with a laser-engraved scale for precise rotational movements. Loosen the **pan lock knob** and you can rotate the entire head 360° around its base.

*Please note, the **pan lock knob** is indeed a lock and does not offer any type of tension adjustment. This head uses static drag for panning. Do not attempt to apply tension using the pan lock knob or you may damage the mechanism. This knob should only be set to a locked or unlocked position but nothing in between.*

The **tilt adjustment knob** controls the tension of the head's tilt adjustment. When this knob is fully tightened it will lock the tilt axis, thereby holding it in a fixed position. When loosened, the head can be tilted up to 90° forward and 60° backward. (The head features an etched scale with degree markings to aid in making precise, repeatable movements.) The **tilt adjustment knob** allows for some tension control. This means that you can adjust the knob between its fully tightened and fully

loosened positions to apply varying amounts of tension. Doing this will slow down the movement of your camera and can help achieve smoother motions. Greater tension can be beneficial when working with heavier camera rigs.

Changing the Direction of the QR Platform

In its default setup, your camera mounts to the head in a front-to-back sliding direction. This can be changed to a side-to-side direction, which is particularly useful for mounting a camera with an L-bracket or cage attached. With the **QR plate** removed from the head, notice the large, silver bolt in the top center of the **QR platform**. Remove this bolt using one of the **4mm hex keys** stored in the **control handle** and lift the **QR platform** away from the head. You can reposition the platform in any one of 4 positions at 90° intervals. Replace and tighten the bolt to re-fasten the **QR platform** to the head.

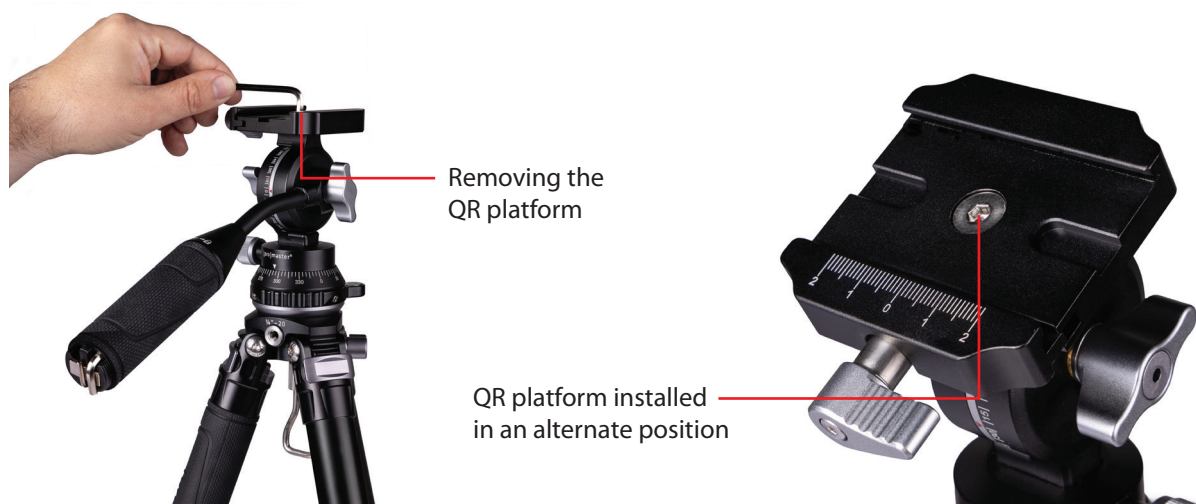

USING THE HEX KEYS

The hex keys stored within the Key Grip's control handle serve a variety of useful purposes, including the following:

- Tightening a QR plate to a camera or lens
- Changing the direction of the QR platform on the Key Grip Video Head
- Adjusting grub screws on a tripod or monopod
- Removing certain types of tripod or monopod feet and spikes
- Tightening a tripod leg to a tripod collar
- Installing and removing items to or from a camera cage

Some examples are pictured here.



Adjusting a grub screw with the 2.5mm hex key.



Tightening a leg to the tripod collar using the 4mm hex keys.



Using a 4mm hex key with a tripod foot.

TIPS FOR USE

1. USE THE PAN LOCK PROPERLY

The pan lock knob should either be tightened to lock the panning motion of the video head, or fully loosened to allow free panning movement. Bear in mind this knob cannot control tension. The panning movement uses static drag only. Do not attempt to control tension with this knob or the internal mechanism may become damaged when you attempt to rotate the head. The knob should only be set to a locked or unlocked position but nothing in between.

2. MAKE ADJUSTMENTS WITH YOUR GEAR IN MIND

The Key Grip provides several ways to customize its operation to best suit your rig, starting with a long QR plate which lets you balance your equipment before using the tripod. Depending on the size and weight of your equipment and the type of movements you will be making, you may prefer to use the control handle in its extended or collapsed position. Finally, adjust the tilt adjustment tension to best suit your preferences.

3. PAIR THE HEAD WITH AN APPROPRIATE TRIPOD

A head is only as good as the legs beneath it. To gain the full potential from the Key Grip, mount it to a quality tripod and be sure to set it up properly for maximum stability. Head to your nearest ProMaster retailer for expert advice.

PRECAUTIONS

1. The Key Grip Video Head is not water resistant. Do not submerge it or expose it to heavy rain or snow.
2. Never expose the Key Grip to salt water.
3. Make sure that everything is properly locked down and secure before operating the head. This includes the QR knob, pan lock knob, and tilt adjustment knob.
4. Always make sure the QR plate is securely attached to your camera before mounting it to the Key Grip, and make sure that the QR knob is fully tightened before operating the head.

ONE YEAR UNCONDITIONAL WARRANTY

If for any reason, this ProMaster product fails with ONE YEAR of the date of purchase, return this product to your ProMaster dealer and it will be exchanged for you at no charge. ProMaster products are guaranteed for ONE FULL YEAR against defects in workmanship and materials. If, at any time after one year, your ProMaster product fails under normal use, we invite you to return it to ProMaster for evaluation.

Code 77813

Made in China

WWW.PROMASTER.COM